

2

1

B

B

A

A

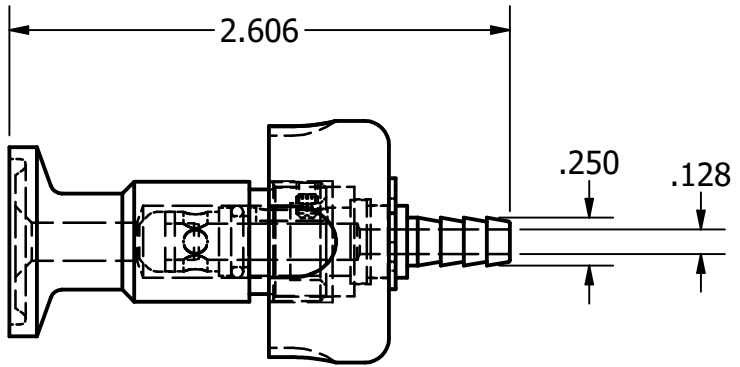
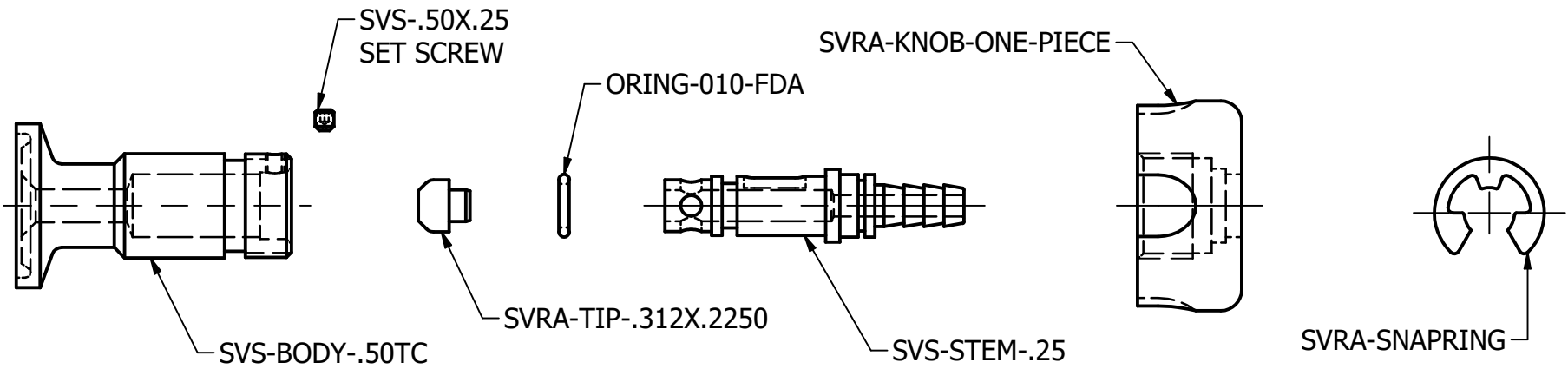

| REVISION HISTORY |                                   |         |
|------------------|-----------------------------------|---------|
| REV              | DESCRIPTION                       | DATE    |
| 1                | KAC00560M WAS KAC00566 & KAC00560 | 1/15/14 |
| 2                | KAC00561 WAS KAC00560M            | 8/2/17  |

|  |  |
|--|--|
| TOLERANCES   | DRAWN<br>Engineering<br>5/17/2007                                |
| DECIMALS:<br>.XX ±.015<br>.XXX ±.005<br>.XXXX ±.0005<br>ANGLES: 1° | ALL EDGES AND<br>FILLETS .015 R<br>UNLESS OTHERWISE<br>SPECIFIED |

|   |              |
|---|--------------|
| <b>Steel &amp; O'Brien Mfg. Inc.</b>              |              |
| TITLE<br>.500 TC SAMPLE VALVE W/STRAIGHT 1/4 BARB |              |
| DWG NO: <b>SVS-.50X.25</b>                        | REV<br>2     |
| SCALE: 1 : 1                                      | SHEET 1 OF 1 |

2

1

| REV | DESCRIPTION                       | DATE    |
|-----|-----------------------------------|---------|
| 1   | KAC00560M WAS KAC00566 & KAC00560 | 1/15/14 |
| 2   | KAC00561 WAS KAC00560M            | 8/2/17  |