

PART #	RUN O.D.	BRANCH O.D.	A	B	C
7RMP-1X.50	1.000	.500	2.625	5.250	2.625
7RMP-1X.75	1.000	.750	2.625	5.250	2.625
7RMP-15X.75	1.500	.750	2.875	5.750	2.875
7RMP-15X1	1.500	1.000	2.156	4.313	1.875
7RMP-2X1	2.000	1.000	2.563	5.125	2.125
7RMP-2X15	2.000	1.500	2.563	5.125	2.406
7RMP-25X.50	2.500	.500	3.625	7.250	3.375
7RMP-25X1	2.500	1.000	2.844	5.688	2.375
7RMP-25X15	2.500	1.500	2.844	5.688	2.656
7RMP-25X2	2.500	2.000	2.844	5.688	2.813
7RMP-3X1	3.000	1.000	3.094	6.188	2.625
7RMP-3X15	3.000	1.500	3.094	6.188	2.906
7RMP-3X2	3.000	2.000	3.094	6.188	3.062
7RMP-3X25	3.000	2.500	3.094	6.188	3.094
7RMP-4X1	4.000	1.000	4.063	8.125	3.125
7RMP-4X15	4.000	1.500	4.063	8.125	3.406
7RMP-4X2	4.000	2.000	4.063	8.125	3.562
7RMP-4X25	4.000	2.500	4.063	8.125	3.594
7RMP-4X3	4.000	3.000	4.063	8.125	3.594
7RMP-6X3	6.000	3.000	6.375	12.750	6.000
7RMP-6X4	6.000	4.000	6.375	12.750	5.500

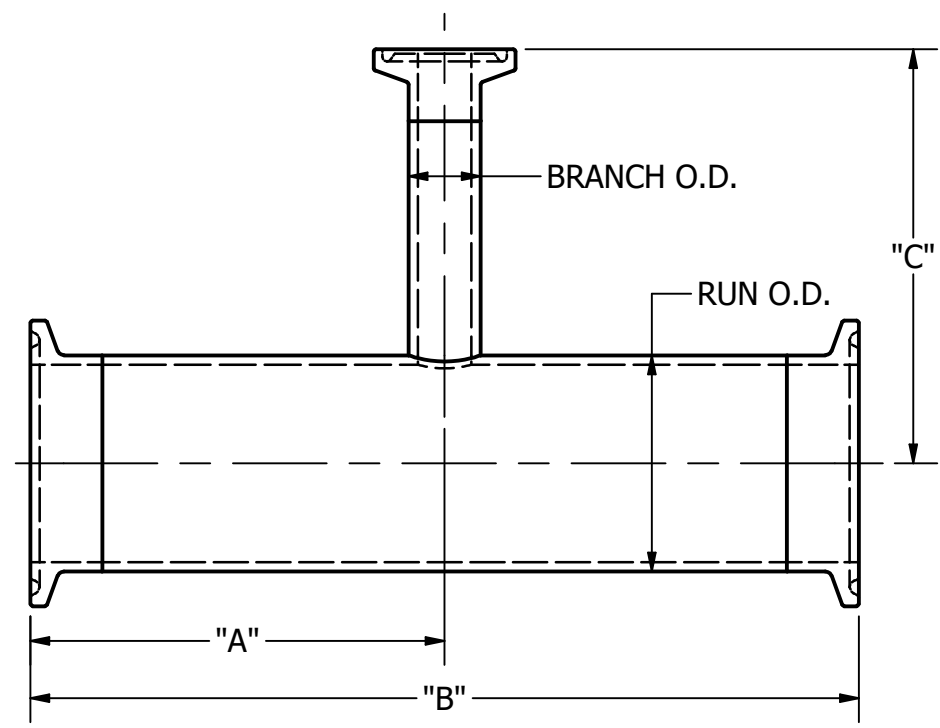

B

B

A

A

REVISION HISTORY

REV	DESCRIPTION	DATE	BY
1	CHANGED "C" DIMENSIONS	11/04/10	JCS
2	ADDED NEW SIZES	6/16/11	JCS
3	6.000 WAS 5.250	8/22/12	PB
4	4" BRANCH DIMENSIONS CHANGED	3/15/13	RC

TOLERANCES

REFER TO
STEEL & O'BRIEN
DOCUMENT # QS121

Steel & O'Brien Mfg. Inc.

TITLE

7RMP - REDUCING CLAMP TEE

DWG NO: **7RMP**

REV

4

SCALE: 1 : 1

SHEET 1 OF 1

2

1

PART #	RUN O.D.	BRANCH O.D.	A	B	C
7RMP-1X.50	1.000	.500	2.625	5.250	2.625
7RMP-1X.75	1.000	.750	2.625	5.250	2.625
7RMP-15X.75	1.500	.750	2.875	5.750	2.875
7RMP-15X1	1.500	1.000	2.156	4.313	1.875
7RMP-2X1	2.000	1.000	2.563	5.125	2.125
7RMP-2X15	2.000	1.500	2.563	5.125	2.406
7RMP-25X.50	2.500	.500	3.625	7.250	3.375
7RMP-25X1	2.500	1.000	2.844	5.688	2.375
7RMP-25X15	2.500	1.500	2.844	5.688	2.656
7RMP-25X2	2.500	2.000	2.844	5.688	2.813
7RMP-3X1	3.000	1.000	3.094	6.188	2.625
7RMP-3X15	3.000	1.500	3.094	6.188	2.906
7RMP-3X2	3.000	2.000	3.094	6.188	3.062
7RMP-3X25	3.000	2.500	3.094	6.188	3.094
7RMP-4X1	4.000	1.000	4.063	8.125	3.125
7RMP-4X15	4.000	1.500	4.063	8.125	3.406
7RMP-4X2	4.000	2.000	4.063	8.125	3.562
7RMP-4X25	4.000	2.500	4.063	8.125	3.594
7RMP-4X3	4.000	3.000	4.063	8.125	3.594
7RMP-6X3	6.000	3.000	6.375	12.750	6.000
7RMP-6X4	6.000	4.000	6.375	12.750	5.500

REV	DESCRIPTION	DATE	BY
1	CHANGED "C" DIMENSIONS	11/04/10	JCS
2	ADDED NEW SIZES	6/16/11	JCS
3	6.000 WAS 5.250	8/22/12	PB
4	4" BRANCH DIMENSIONS CHANGED	3/15/13	RC