

Gasket Groove Detail
1/2" & 3/4" Sizes

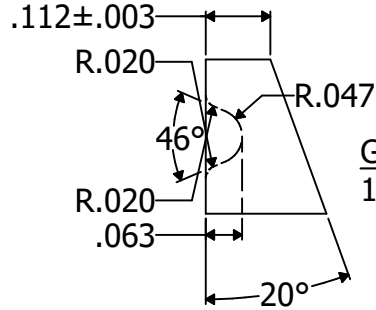

Gasket Groove Detail
1" to 5" Sizes

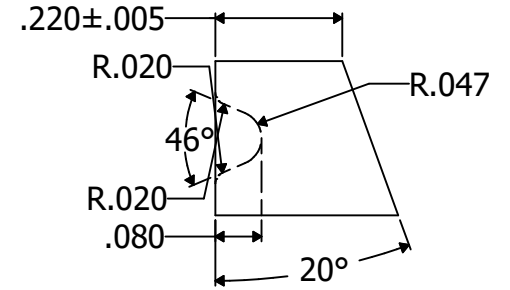

Gasket Groove Detail
6" to 12"
* = .080 for 8" to 12"

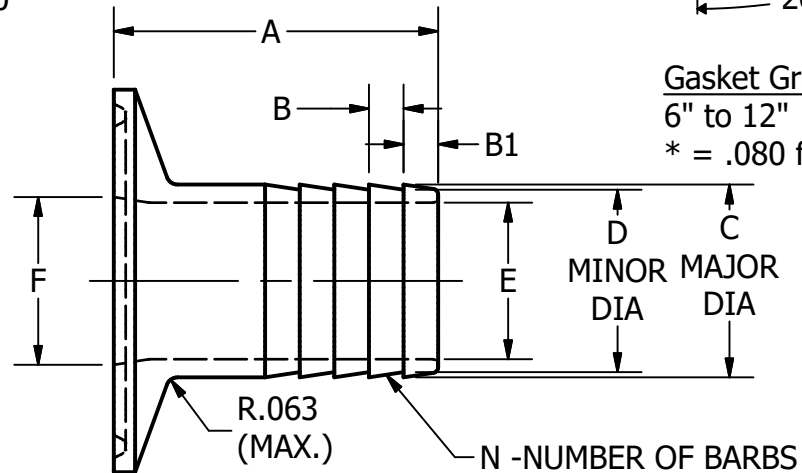
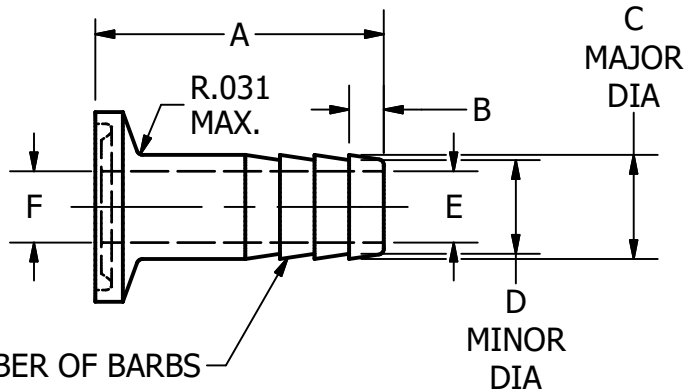

Part #	Size	A	B1	B	N	C	D	E	F
14MPHR-.50	.500	1.500	.180	.180	4	.540	.486	.370	.370
14MPHR-.75	.750	1.500	.180	.180	5	.767	.713	.618	.618
14MPHR-1	1.000	1.687	.180	.180	5	1.000	.946	.812	.870
14MPHR-1.5	1.500	1.687	.180	.180	5	1.500	1.446	1.312	1.370
14MPHR-2	2.000	2.312	.180	.180	5	2.000	1.946	1.810	1.870
14MPHR-2.5	2.500	2.343	.100	.400	4	2.500	2.446	2.312	2.370
14MPHR-3	3.000	3.093	.100	.400	6	3.000	2.946	2.812	2.870
14MPHR-4	4.000	3.406	.100	.400	7	4.000	3.946	3.812	3.834
14MPHR-6	6.000	3.406	.100	.400	7	6.000	5.946	5.728	5.782
14MPHR-8	8.000	3.406	.100	.400	7	8.000	7.946	7.728	7.782

REVISION HISTORY

REV	DESCRIPTION	OLD	NEW	DATE	BY
1	Updated Gasket Groove			8/20/14	
2	UPDATED AAR00760 C, D, E, F DIMENSIONS	.840, .786, .625, .625	.767, .713, .618, .618	7/5/17	KL

TOLERANCES

REFER TO
STEEL & O'BRIEN
DOCUMENT # QS121

Steel & O'Brien Mfg. Inc.

TITLE

14MPHR RUBBER HOSE ADAPTER

DWG NO: **14MPHR**

REV

2

SCALE: 1 : 1

SHEET 1 OF 1