

PART NO.	OAL	A	B
7MMW-1	3.250	1.625	1.125
7MMW-1.5	4.312	2.156	1.656
7MMW-2	5.125	2.563	2.063
7MMW-2.5	5.688	2.844	2.344
7MMW-3	6.188	3.094	2.594
7MMW-4	8.125	4.063	3.438

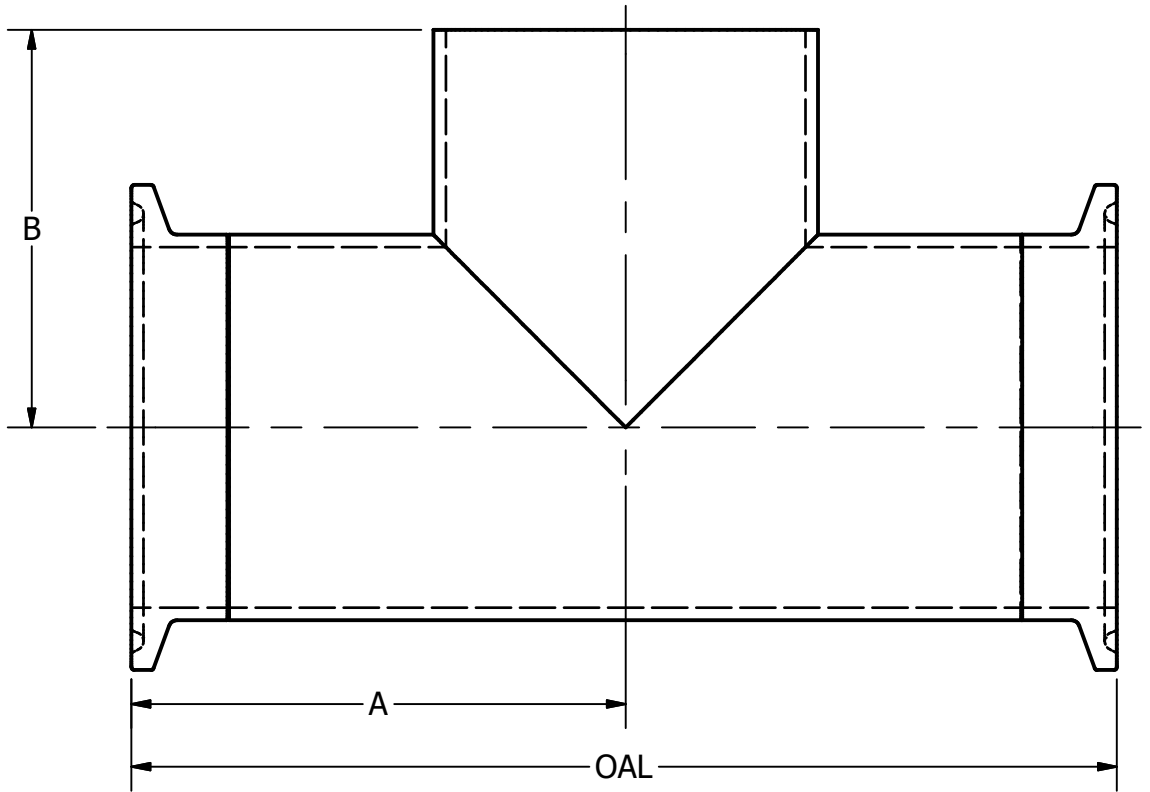

TOLERANCES

REFER TO
STEEL & O'BRIEN
DOCUMENT # QS121

Steel & O'Brien Mfg. Inc.

TITLE
TC X TC X BW TEE

DWG NO: **7MMW**

SCALE: N/A

REV

SHEET 1 OF 1